

SPECIFICATIONS:

DESCRIPTION

- Hi reliability filtering in multi row arrangements
- Stamped and Formed shells
- Screw Machine Contacts and Hi Reliability inserts
- Available in all Hi-Density insert patterns

MATERIALS AND PLATINGS

Shells	Stamped steel shell, tin plated
Inserts	High temperature resistant polyethersulfone per MIL-P-46185
Contacts	Machined copper alloy, 20µ" (0.51µm) gold plated over nickel
Capacitor	Barium titanate ceramic array

ELECTRICAL DATA

Current Rating	5 A
Insulation Resistance	5 GIGOHM @ 500 VDC
Working Voltage	200 VDC
D.W.V.	500 VDC pin to pin & pin to shell
Capacitance	+/- 20% (see P/N description)

CLIMATIC DATA

Operating Temperature	-67°F to +257°F (-55°C to +125°C)
-----------------------	-----------------------------------

For 50 position and all high density versions. Amphenol's FD308 Filtered D-Subminiature connectors are available in the full range of hi-density insert arrangements, pin and socket contacts, plus the 50 position standard density. These connectors are supplied with fixed screw machine contacts and are available in Straight and Right Angle PCB terminations and Solder Cup.

- Computers and Peripheral Equipment
- Avionics Systems Ideal For Retrofit Applications Or Late Design-In

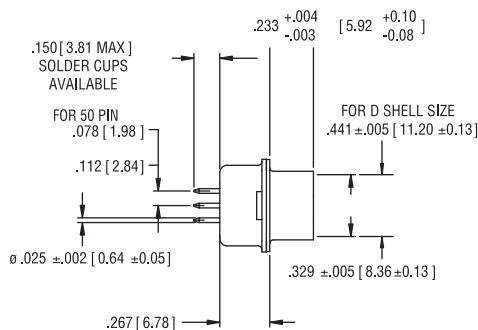

PLUG - SIDE VIEW

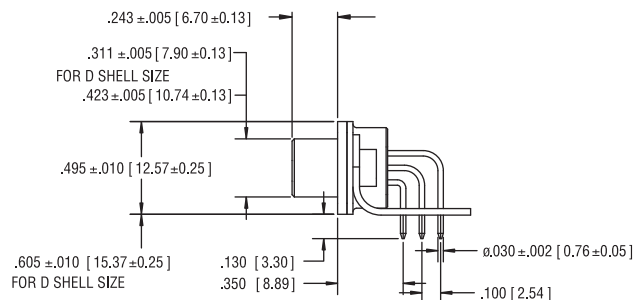

RECEPTACLE - SIDE VIEW

FD308 - B44 - S - A - 1 - A2 - 000

Series Designation

Size & Number Of Contacts

STD Density E09, A15, B25, C37, D50
High Density E15, A26, B44, C62, D78, 6104

Contact Type

S = Socket Contact P = Pin Contact

Termination Style

A = Right Angle pcb
B = Vertical pcb
C = Solder Cup

000 = Standard part
other deviations as required

Capacitance Code

A2 = 200 PF 02 = 2000 PF
A4 = 400 PF 05 = 5000 PF
01 = 1000 PF

Mounting Type

1 = 4-40 Clinch Nut
2 = Ø.120 (3.05) Hole
3 = R/A Mounting Bracket
4 = 4-40 Clinch Nut
with R/A Mounting Bracket